

NOTE: You will need about a 1" (25mm) clearance to lift panel onto the French cleat. If you are mounting at the top of a wall at the ceiling, panels will need a minimum 1" (25mm) between the top of the cord and ceiling.

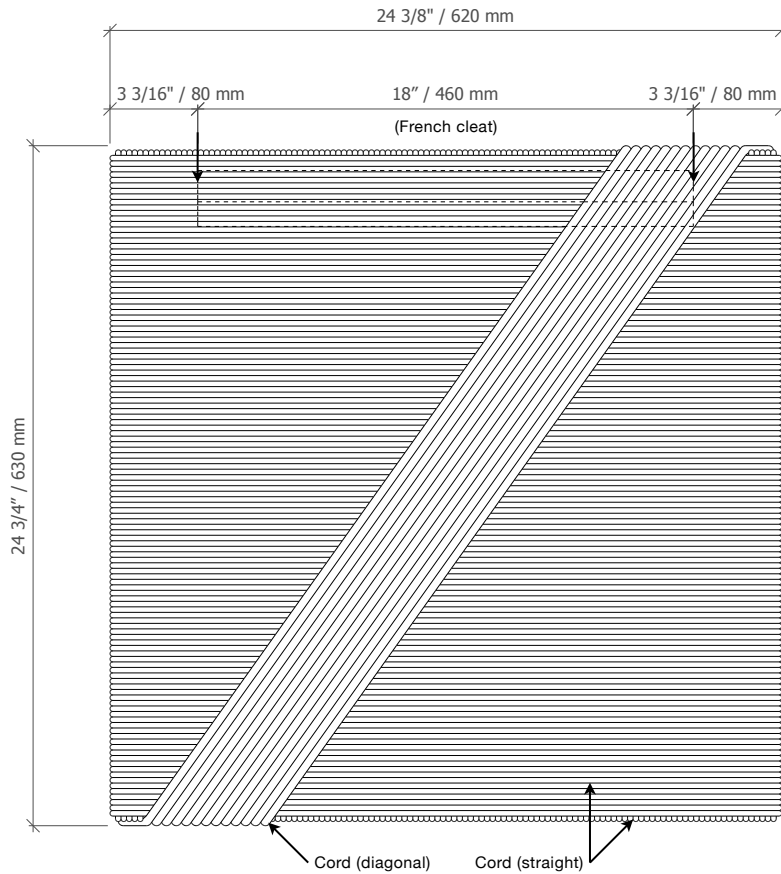

1 FRONT ELEVATION
SCALE: N/A

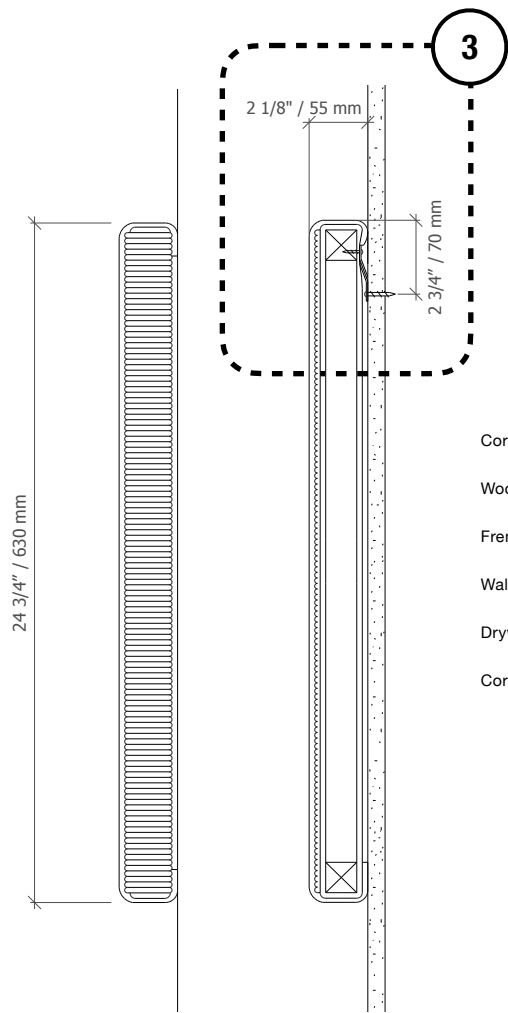

2 SIDE ELEVATION / SECTION
SCALE: N/A

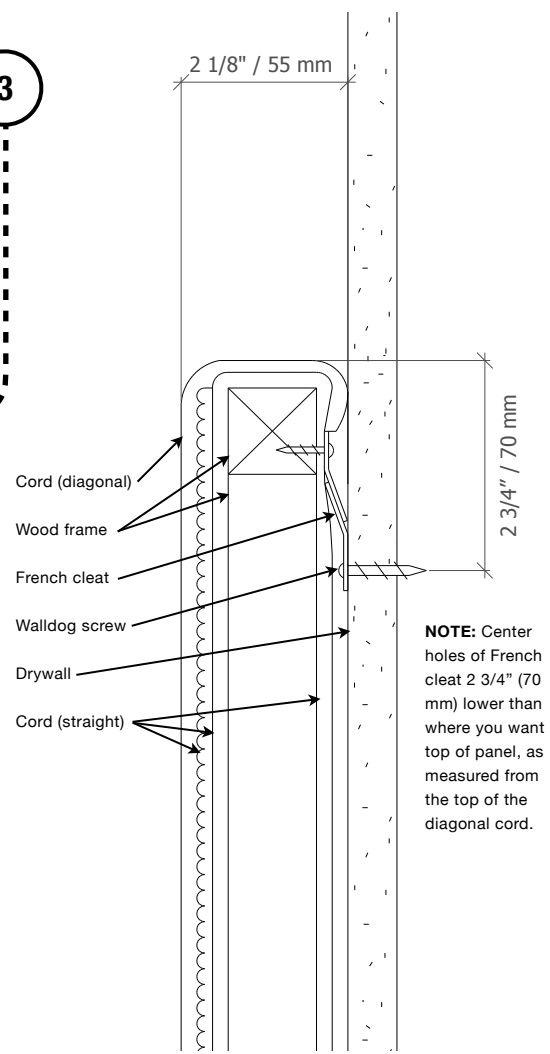

3 DETAIL
SCALE: N/A

NOTE: Center holes of French cleat 2 3/4" (70 mm) lower than where you want top of panel, as measured from the top of the diagonal cord.

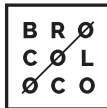

BROCOLOCO

COLORCORD™ Panels

Wall mounting instructions.

Maintenance: blow free of dust with compressed air or vacuum occasionally.

01