

NOTE: Top of panel will need at least 1/2" (13 mm) clearance below ceiling or top of wall in order to lift it over front of wall mount.

If a flush top edge is desired, the wall mounts can be held in place on the panel as the panel is moved into position. Screw the hardware into wall while holding the panel in position by shifting a temporary gap between the large ropes in front of the wall mounts.

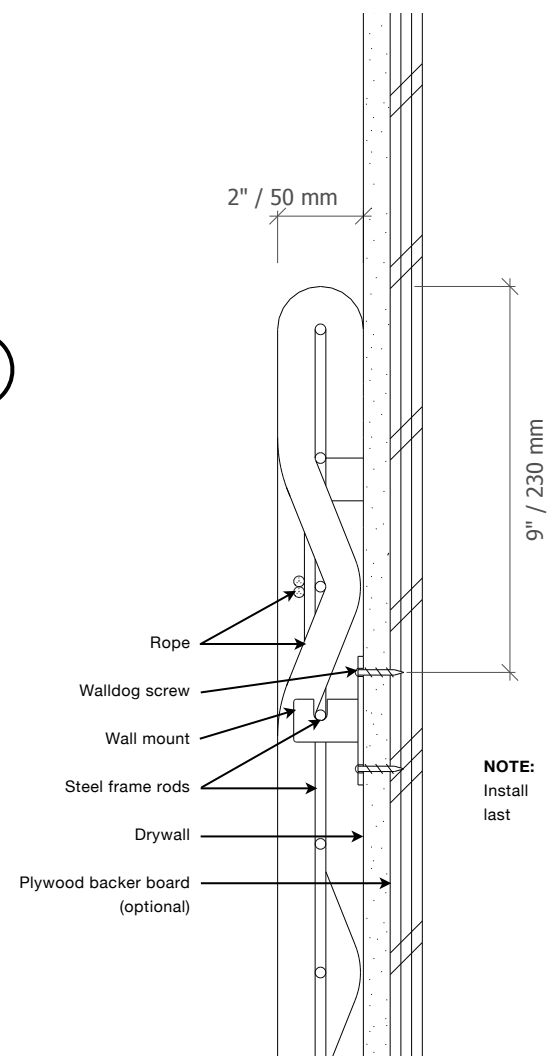
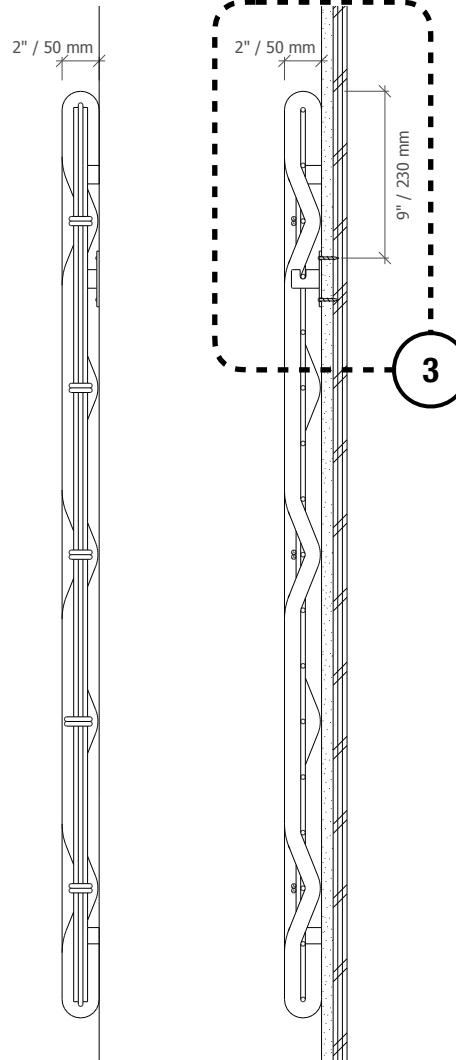

NOTE: Install last

1 FRONT ELEVATION
SCALE: N/A

2 SIDE ELEVATION / SECTION
SCALE: N/A

3 DETAIL
SCALE: N/A



BROCOLOCO

BASKETWEAVE™ Rope Panels

Vertical orientation // wall mounting instructions.

Maintenance: blow free of dust with compressed air or vacuum as needed.

01

NOTE: Install the top hanging mount after the bottom hanging mounts are installed and the rope panel has been placed onto the bottom hanging mounts. Slip the top hanging mount on upside-down onto the top of the panel just off of center to the side of the small center rope. Set between the steel frame rods at the panel's edge with the small perimeter rope in front. Hold panel firmly against the wall with the mount in position, and nudging a space between large ropes **A** and **B**, place the Walldog screws between the ropes and screw them through the bracket into the wall. This will secure the panel firmly to the wall and prevent accidental removal or bumping. Hanging mounts can be placed in various perimeter locations along the panel's 3" (75 mm) grid frame if an installer wishes to place them into a stud.

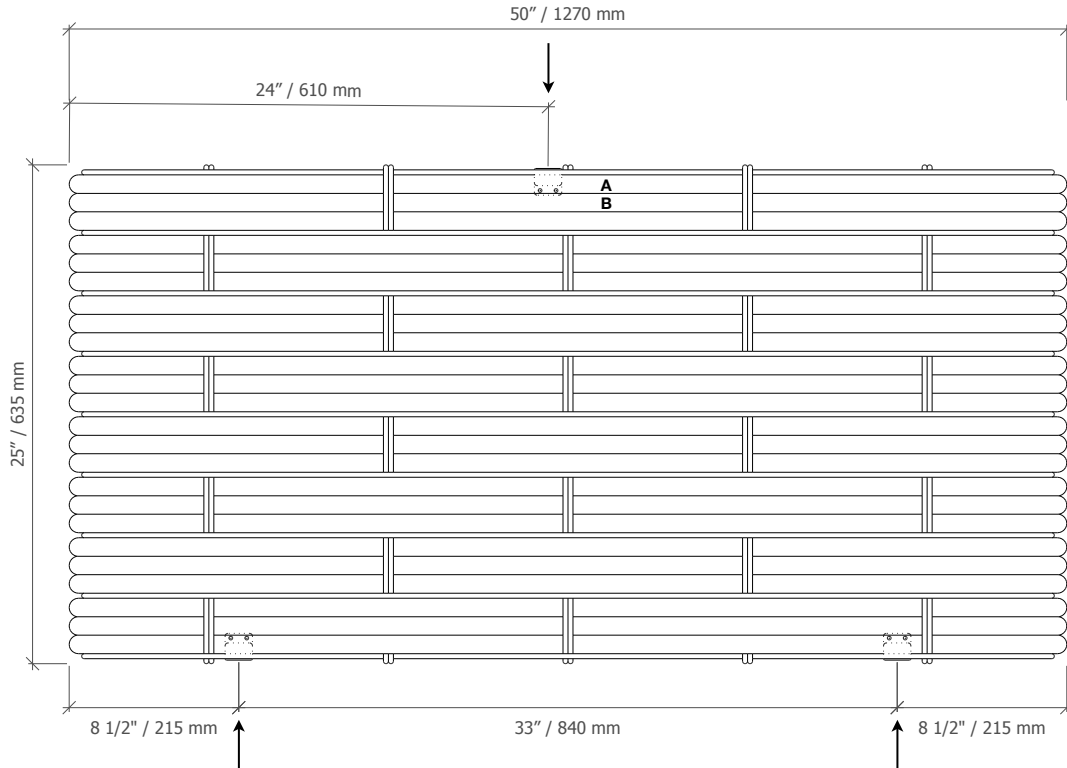

NOTE: Install the bottom hanging mounts first, centered 8 1/2" (215 mm) from sides of panel. This leaves 1" (25 mm) of space to shift the panel right or left. Align screw holes of hanging mounts 1 1/4" (32 mm) higher than where you want the bottom of the panel. Set the panel onto the mounts with the front tab of the mount interlocking into the center of the panel's edge between the steel frame rods. Make sure the small perimeter rope is positioned in front of the bracket. Finally, install the top hanging mount. If stacking vertical rows of rope panels, place lower hanging mounts in rows 25" (635 mm) above each other. As you fill in the panels onto the wall, add the top hanging mounts to secure them.

1 FRONT ELEVATION
SCALE: N/A

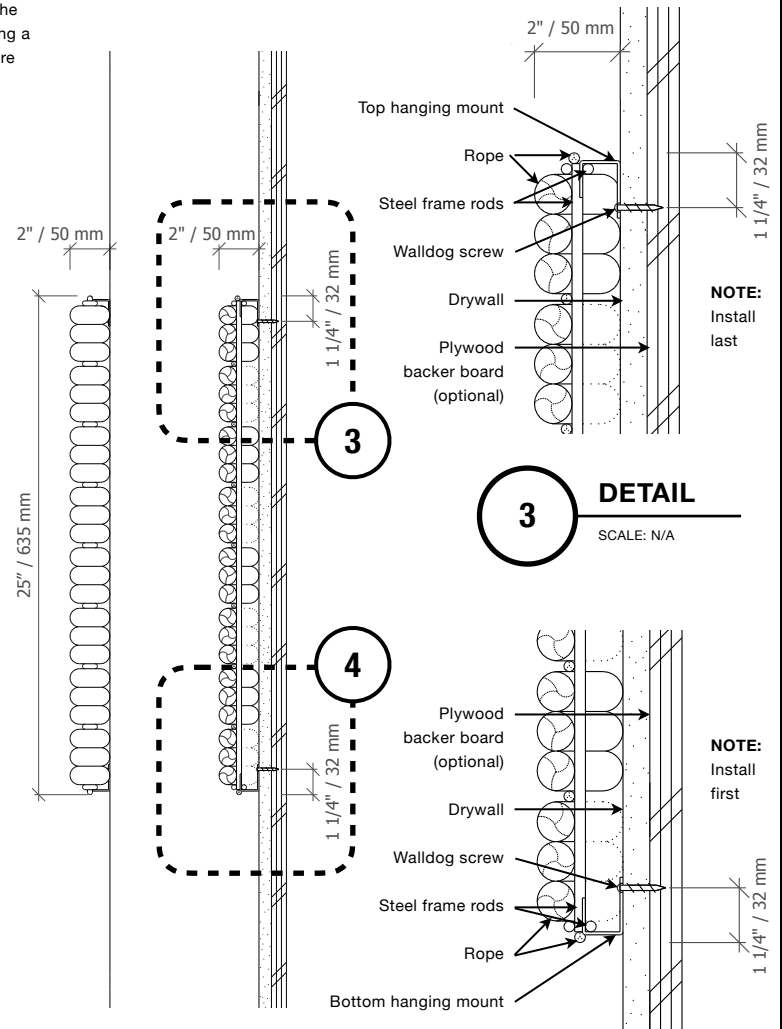

2 SIDE ELEVATION / SECTION
SCALE: N/A

4 DETAIL
SCALE: N/A

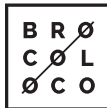

BROCOLOCO

BASKETWEAVE™ Rope Panels

Horizontal orientation // wall mounting instructions.

Maintenance: blow free of dust with compressed air or vacuum as needed.

02

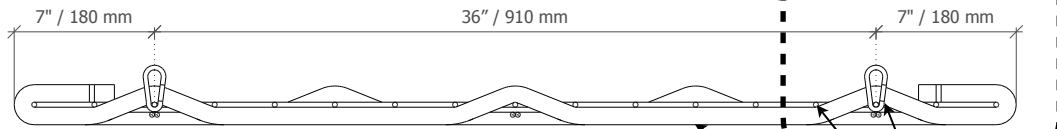

1 SIDE SECTION
SCALE: N/A

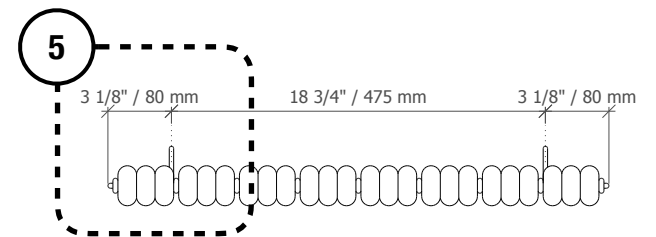

3 SIDE ELEVATION
SCALE: N/A

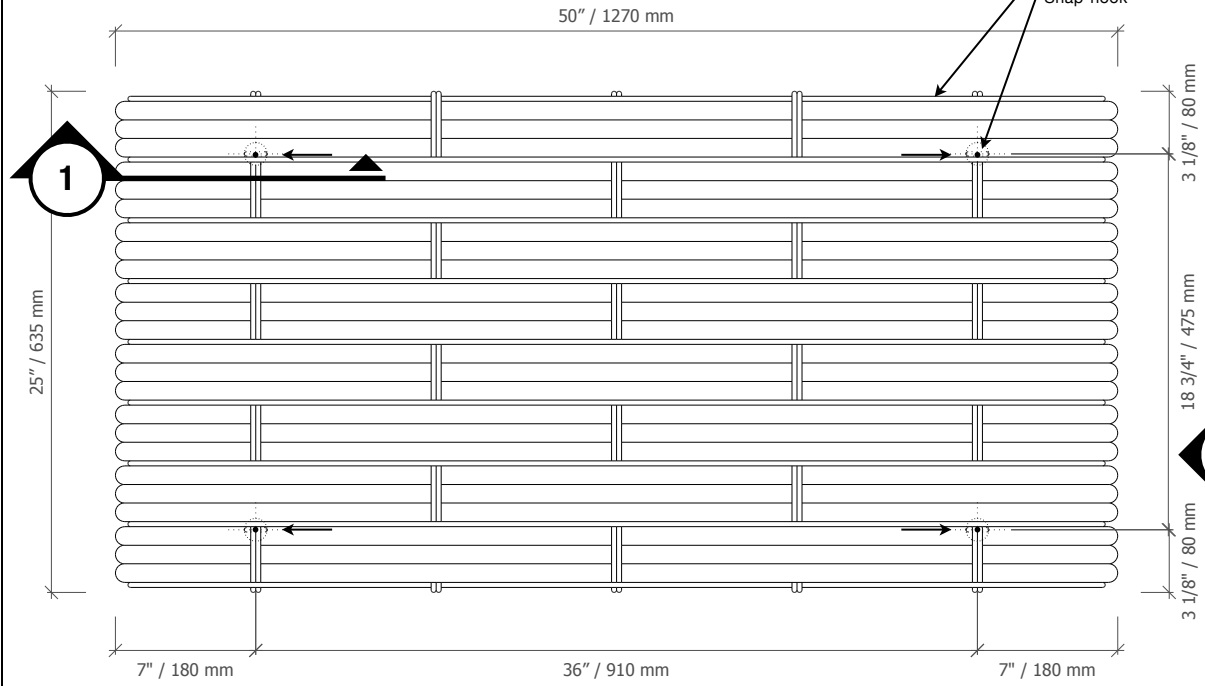

2 REFLECTED CEILING VIEW
SCALE: N/A

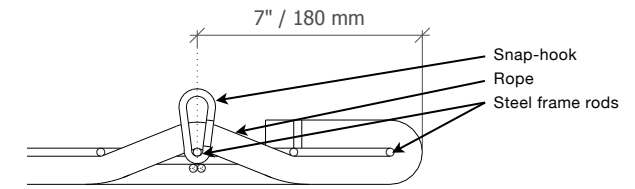

4 DETAIL
SCALE: N/A

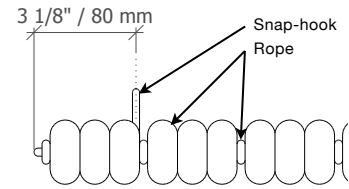

5 DETAIL
SCALE: N/A

NOTE: A number of hardware solutions will work for connecting the panel's snap-hooks to the ceiling, such as using aircraft cable for a suspended mount or using an eye-hook screwed into blocking for more of a flush mount. A screw-eye and toggle bolt setup may be possible for a drywall ceiling. Make sure all hardware and systems are sufficient for a minimum standard panel weight of 28 lbs (13 kg).

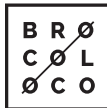

BROCOLOCO

BASKETWEAVE™ Rope Panels

Suspended orientation // ceiling mounting instructions.

Maintenance: blow free of dust with compressed air or vacuum as needed.

03